

N 154,200

N 152,800

E 2,080,300

E 2,082,000

STARFIRE CT.
DR.

DR.

NEWPORT

STEVEN DR.

DR.

R.D.

MILL



COUNTY OF NASSAU
 LOT NOS: 47, 48 & 51

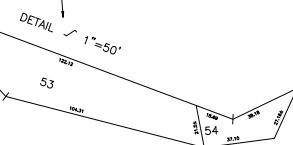

COPYRIGHT 1988 NASSAU COUNTY

LEGEND	
COUNTY LINE	---
TOWN LINE	----
VILLAGE LINE	-----
SCHOOL DISTRICT LINE	-----
PROPERTY LINE	-----
SPECIAL DISTRICT LINE	-----
BLOCK LIMIT	-----
LOCATOR POINT	*
TAX MAP PARCEL NO.	246
CALCULATED ACREAGE	754(C)
DEED ACREAGE	1764
SCALED DIMENSION	327(S)
DEED DIMENSION	185.89
REFERENCE MAPS	
MAP NO.	

POLICE		DIST
County Police		3
WATER		DIST
LIGHTING		DIST
Town of Hempstead		47
LIBRARY		DIST
FIRE		DIST

FIRE PROTECTION		DIST
West Sunbury		117
SANITARY		DIST
Sanitary District 1		91
REFUSE & GARBAGE		DIST
REFUSE DISPOSAL		DIST
SEWAGE COLLECTION		DIST
Sewage Collection District #2-WH		E

SPECIAL DISTRICTS		DIST
PUBLIC PARKING		DIST
SEWER		DIST
Nassau County Sewage Disposal District #2		202
PARK		DIST
Town of Hempstead		V
IMPROVEMENT		DIST
SIDEWALK		DIST

DRAINAGE		DIST
FIRE HYDRANT RENTAL		DIST
GARBAGE		DIST
ESCALATOR		DIST
WATER POLLUTION CONTROL		DIST
Town, County, College, Police HQ		1
Town Building Dept, Zoning & Appeals, Unincorporated Area		2

MUNICIPALITIES		DIST
TOWN OF:		
HEMPSTEAD		
NORTH HEMPSTEAD		
OYSTER BAY		
CITY OF:		
GLEN COVE		
LONG BEACH		
VILLAGE OF:		
SCHOOL DISTRICT		DIST
Hewlett - Woodmere		14



Nassau County
 Department of Assessment
 Charles O'Shea, Chairman
Land & Tax Map

Map Last Revised: October 7 2002

SEC. 39
BLK. 577

SHEET 1 OF 1

CODE	SPECIAL	DISTRICT	WITHIN	CODE	SPECIAL	DISTRICT	WITHIN	CODE	SPECIAL	DISTRICT	WITHIN
019	1	117	2	202	3	47	91	E	V		
425	1	202	3	E							