

N 185,350

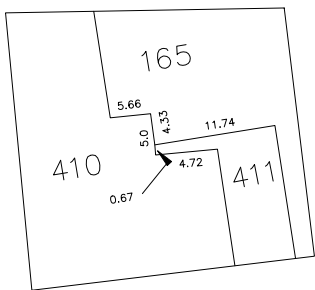

E 2,154,200



DETAIL SCALE - 1" = 10'

N 184,600
 E 2,153,450

INC. Village of FARMINGDALE
 LOT NOS: 414, 415
 ST. KILIANS R.C. CHURCH
 LOT NOS: 413, 173

LEGEND

COUNTY LINE	---
TOWN LINE	- - - -
VILLAGE LINE	— · — · —
SCHOOL DISTRICT LINE	— · — · —
PROPERTY LINE	— · — · —
SPECIAL DISTRICT LINE	— · — · —
BLOCK LIMIT	— · — · —
LOCATOR POINT	*
TAX MAP PARCEL NO.	246
CALCULATED ACREAGE	75A(C)
DEED ACREAGE	176
SCALED DIMENSION	327(S)
DEED DIMENSION	185.09
REFERENCE MAPS	
MAP NO.	

POLICE

County Police	
WATER	
LIGHTING	
LIBRARY	
FIRE	

SPECIAL DISTRICTS

FIRE PROTECTION	
SANITARY	
REFUSE & GARBAGE	
REFUSE DISPOSAL	
SEWAGE COLLECTION	
Sewage Collection District #3-F	21
Town of Oyster Bay	65

SPECIAL DISTRICTS

PUBLIC PARKING	
SEWER	
Nassau County Sewage Disposal District #3	30
PARK	
IMPROVEMENT	
SIDEWALK	

SPECIAL DISTRICTS

DRAINAGE	
FIRE HYDRANT RENTAL	
GARBAGE	
Garbage District #2	53
ESCALATOR	
WATER POLLUTION CONTROL	
Town, County, College, Police HQ	1

MUNICIPALITIES

TOWN OF: HEMPSTEAD	
NORTH HEMPSTEAD	
OYSTER BAY	
CITY OF: GLEN COVE	
LONG BEACH	
VILLAGE OF: Farmingdale	
Incorporated Village of Farmingdale	
SCHOOL DISTRICT	
Farmingdale	22



Nassau County
 Department of Assessment
 James E. Davis, Acting Assessor
Land & Tax Map
 Map Last Revised: June 24 2014

SEC. 49
BLK. 106

CODE	SPECIAL	DISTRICT	WITHIN	CODE	SPECIAL	DISTRICT	WITHIN	CODE	SPECIAL	DISTRICT	WITHIN
800	1	21	3	30	53	56					