

200' 100' 0' 200' 400'



SCALE: 1" = 200'

N 236,000

LAUREL HOLLOW

COLD

SPRING

HARBOR

INC. VILLAGE OF LAUREL HOLLOW

(LAURELTON BEACH RD)

ROAD

RIDGE

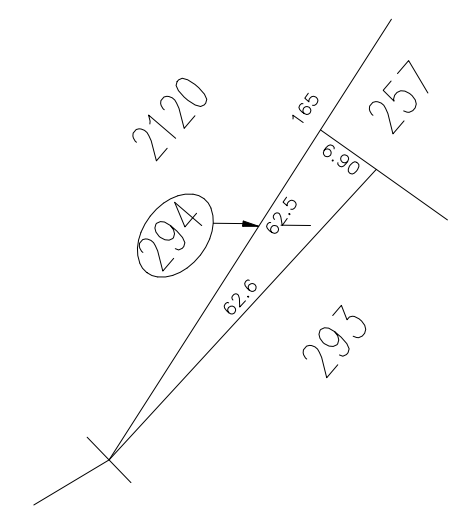

DETAIL SCALE - 1" = 30'

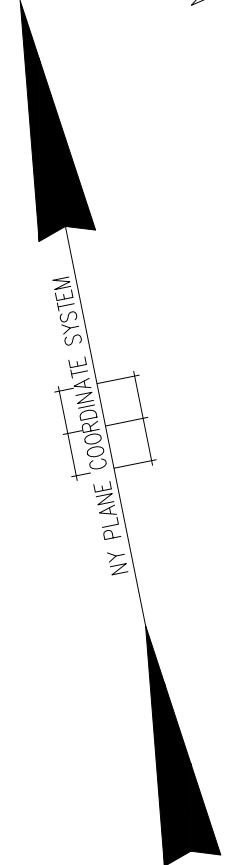

N 234,200

E 2,145,000

COPYRIGHT 1998 NASSAU COUNTY

LEGEND				SPECIAL DISTRICTS				MUNICIPALITIES			
COUNTY LINE	---	POLICE	DIST	FIRE PROTECTION	DIST	PUBLIC PARKING	DIST	DRAINAGE	DIST	TOWN OF: HEMPSTEAD	 <p>Nassau County Department of Assessment Land & Tax Map</p>
TOWN LINE	- - - -	WATER		SANITARY		SEWER		FIRE HYDRANT RENTAL		CITY OF: GLEN COVE	
VILLAGE LINE	- · - · -	LIGHTING		REFUSE & GARBAGE		PARK		GARBAGE		VILLAGE OF: LONG BEACH	
SCHOOL DISTRICT LINE	- · - · -	LIBRARY		REFUSE DISPOSAL		IMPROVEMENT		ESCALATOR		Incorporated Village of Laurel Hollow	
PROPERTY LINE	— · — · —	FIRE		SEWAGE COLLECTION		SIDEWALK		WATER POLLUTION CONTROL			
SPECIAL DISTRICT LINE	— · — · —							Town, County, College, Police HQ	1		
BLOCK LIMIT	— · — · —										
LOCATOR POINT	•										
TAX MAP PARCEL NO.	246										
CALCULATED ACREAGE	754(C)										
DEED ACREAGE	1764										
SCALED DIMENSION	327(S)										
DEED DIMENSION	185.69										
REFERENCE MAPS											
MAP NO. -											
CODE	SPECIAL	DISTRICT	WITHIN	CODE	SPECIAL	DISTRICT	WITHIN	CODE	SPECIAL	DISTRICT	WITHIN
520	1										



Nassau County Department of Assessment Land & Tax Map

Map Last Revised April 19 2023

SEC. 26
BLK. C

SHEET 3 OF 3