

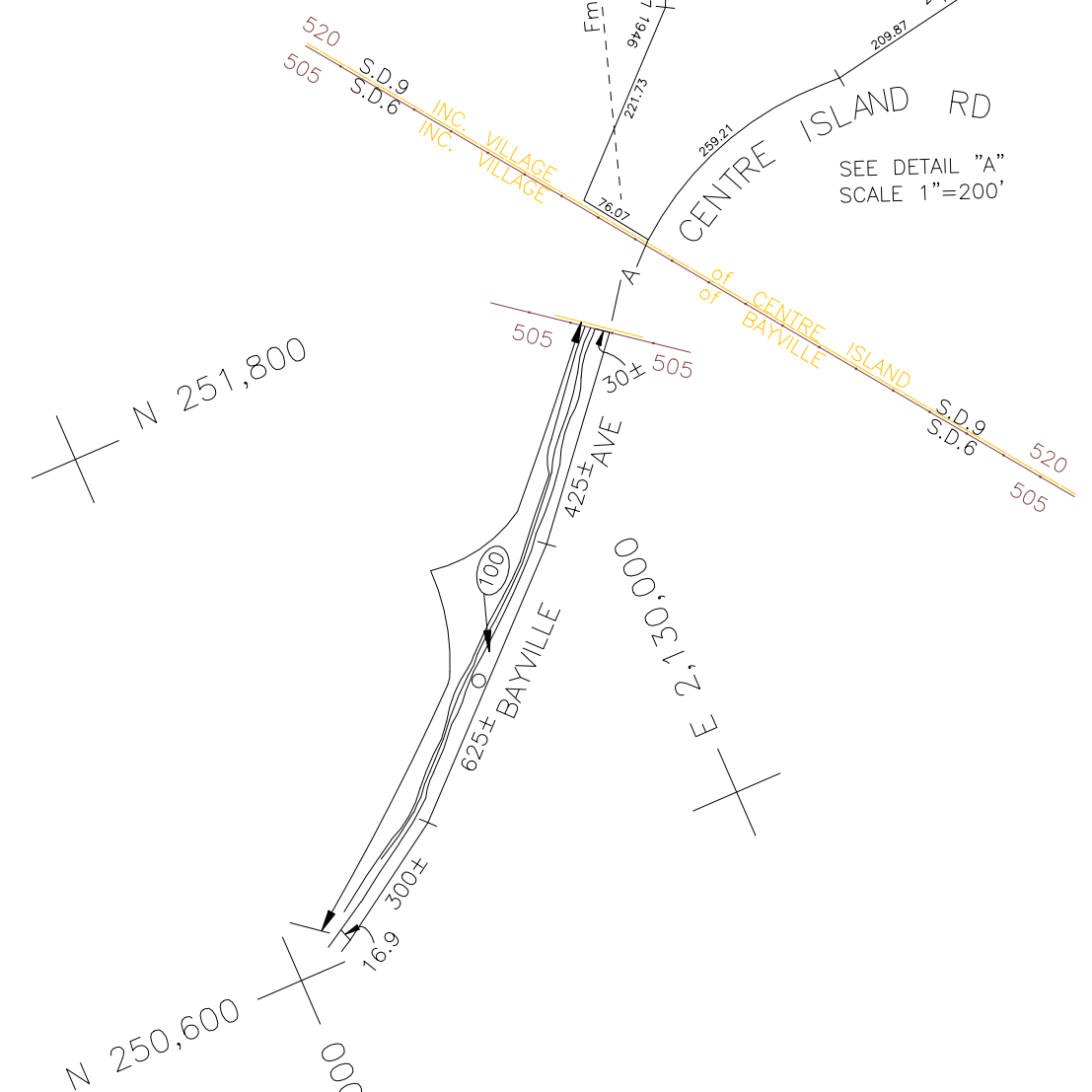

COPYRIGHT 1998 NASSAU COUNTY



LOT NO.: 100  
Town of OYSTER BAY  
  
LOT NO.: 209  
INC. VILLAGE of CENTRE ISLAND

LEGEND				SPECIAL DISTRICTS				MUNICIPALITIES			
COUNTY LINE	---	POLICE	DIST	FIRE PROTECTION	DIST	PUBLIC PARKING	DIST	DRAINAGE	DIST	TOWN OF: HEMPSTEAD	<p>Nassau County Department of Assessment Land &amp; Tax Map Map Last Revised August 06 2025</p>
TOWN LINE	- - - -	WATER		SANITARY		SEWER		FIRE HYDRANT RENTAL		CITY OF: GLEN COVE	
VILLAGE LINE	- · - · -	LIGHTING		REFUSE & GARBAGE		PARK		GARBAGE		LONG BEACH	
SCHOOL DISTRICT LINE	- · - · -	LIBRARY		REFUSE DISPOSAL		IMPROVEMENT		ESCALATOR		VILLAGE OF:	
PROPERTY LINE	— · — · —	FIRE		SEWAGE COLLECTION		SIDEWALK		WATER POLLUTION CONTROL			
SPECIAL DISTRICT LINE	- · - · -										
BLOCK LIMIT	— · — · —										
LOCATOR POINT	•										
TAX MAP PARCEL NO.	246										
CALCULATED ACREAGE	75A(C)										
DEED ACREAGE	176A										
SCALED DIMENSION	327(S)										
DEED DIMENSION	185.69										
REFERENCE MAPS											
MAP NO. -											
CODE	SPECIAL	DISTRICT	WITHIN	CODE	SPECIAL	DISTRICT	WITHIN	CODE	SPECIAL	DISTRICT	WITHIN

SEC. 28  
BLK. B